



232 Branford Road
North Branford, CT 06471
Order Line: (203) 481-9460
Tech Line: (203) 481-9943
Fax Line: (203) 481-9641
www.cantonracingproducts.com

HOW TO INSTALL YOUR ELECTRIC VALVE

PART #24-270

- 1) Install the provided 1/2" N.P.T. pipe nipple into the "IN" end of the electric valve using teflon tape to seal the threads.
- 2) Install the valve onto the Accusump™ by threading the other end of the pipe nipple into the 1/2" N.P.T. port on the Accusump™, using teflon tape to seal the threads. You may need to temporarily remove the blow off valve from the Accusump for this step.

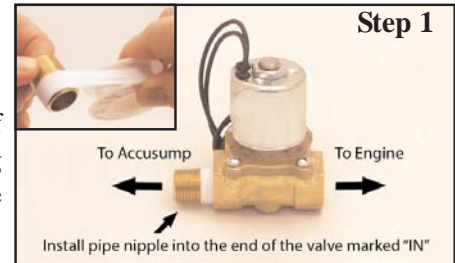

***WARNING** Do not use the valve solenoid as a handle for installation. Use a wrench. Bent valve shafts and damaged solenoids due to improper installation are not covered under warranty.**

- 3) Locate an accessory terminal in your fuse panel that is energized when the ignition is on. On applications without a fuse panel, an accessory terminal on the ignition switch can be used. This terminal should only be energized when the ignition is on. If the lead is not fused, a 4 amp fuse should be installed.
- 4) Install the toggle switch in a convenient location. Power coming from the ignition switch or accessory terminal should run through the toggle switch. This will enable the toggle switch to disable the unit in a situation where the ignition is left on but you do not want the Accusump™ active. When the toggle switch is in the on position the electric valve will be open whenever the ignition is on.

- 5) Run 16-gauge multi-strand wire from the ignition lead to one side of the toggle switch. From the other side of the toggle switch, run a wire to where the electric valve solenoid is positioned.
- 6) Attach this power lead to either of the leads on the electric valve.
- 7) Run the other lead on the electric valve to a chassis ground.
- 8) Plumb your oil feed line to the open end of the electric valve and your installation is complete.

